

Lancing Device

Instructions for Use

PRINCIPLE AND INTENDED USE:

The lancing device is used with compatible disposable sterile lancets to draw capillary blood from the fingertip, palm (at the base of the thumb) or forearm, for blood glucose testing or other testing utilizing small amounts of blood.

IMPORTANT:

Prior to testing, wipe the test site with an alcohol swab or soapy water. Use warm water to increase blood flow if necessary. Then dry your hands and the test site thoroughly. Make sure there is no cream or lotion on the test site.

WARNING:

1. Keep the Lancing Device clean.
2. *The lancing device is for single patient use. Do not share it with anyone including other family members! Do not use on multiple patients!*
3. ⓧ Do not reuse lancet, always use a new, sterile lancet for testing.
4. Use caution whenever the lancet needle is exposed, especially when removing the used lancet from the device and when disposing the used lancet.

CARE OF THE LANCING DEVICE:

1. Remove the Lancing Device Cap. Wash the Lancing Device Cap in warm, soapy water. Rinse well and allow it to dry thoroughly.
2. Clean the remaining outside of the Lancing Device using an alcohol swab or soft cloth with mild soapy water as required.
3. To disinfect the Lancing Device Cap, use a disinfectant dilution (containing 2000 mg/L of chlorine) and immerse for 30 minutes, then wash with water and wait until it is dry. (Hospitals should consult their own infection control protocols)
4. The remaining outside of Lancing Device can be disinfected using 75% Isopropyl Alcohol. Carefully dry the lancing device. Do not immerse the lancing device in liquid.

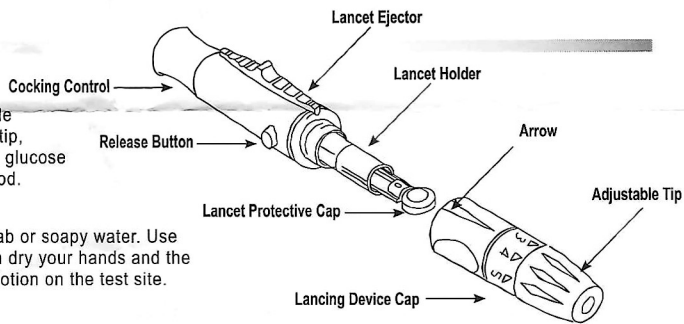

- 1 Twist off the Lancing Device Cap.

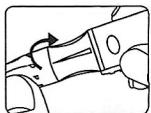

- 2 Insert a new sterile lancet into the Lancet Holder. Push down firmly until it is fully seated.

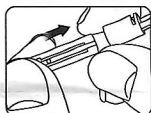

- 3 Twist off the Lancet Protective Cap and save the Cap for later use. Replace the Lancing Device Cap.

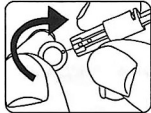

- 4 Set the lancing level by twisting the Adjustable Tip until the number lines up with the Arrow. To select the best depth:
1-2 for soft or thin skin
3 for average skin
4-5 for thick or calloused skin

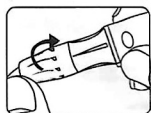

- 5 Slowly pull back the Cocking Control. You will hear a click, indicating that the Lancing Device is now loaded and ready to use.

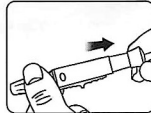

- 6-1 Hold the Lancing Device firmly against the side-tip of the finger. Press the Release Button. Set the Lancing Device aside and proceed with your blood glucose test according to your blood glucose meter's directions.

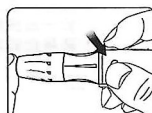

- 6-2 When using AST Cap, place the end of the lancing device against the arm from which the blood sample is to be obtained. Apply pressure and push the Release Button to puncture the skin.

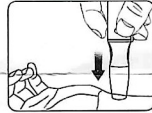

- 7 After use, twist off the Lancing Device Cap. Push the exposed tip of the lancet into its Protective Cap.

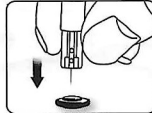

- 8 Slide the Lancet Ejector forward and disposing the used lancet in an approved container. Discard the used lancet according to your country's safety regulations. Replace the Lancing Device Cap.

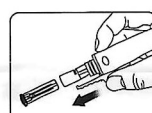

10-92-0220-0002 V2-JUL15