

Canine Parvovirus Ag Rapid Test

1. INTENDED USE

Insight Canine Parvovirus Ag Rapid Test is a sandwich lateral flow immunochromatographic assay for the qualitative detection of canine Parvovirus (CPV Ag) in dog faeces or vomit.

Assay Time: 5-10 min

Sample: Faeces or vomit

2. PRINCIPLE OF THE ASSAY

Insight Canine Parvovirus Ag Rapid Test is based on a sandwich lateral flow immunochromatographic assay. The test device has a testing window containing a T (test) zone and C (control) zone. When sample is applied into the sample well on the device, the liquid will laterally flow on the surface of the test strip. If Parvovirus antigen is present in the sample, a visible T band will appear in the corresponding test window. The C band should always appear after a sample is applied, indicating a valid result. This means the device has accurately indicated the presence of Canine Parvovirus antigen in the sample.

3. KIT COMPONENT

- 10×foil pouches, each containing one cassette, one pipette and a desiccant
- 10×assay buffer tubes (1.0 mL each)
- 10×swab sticks
- Product Insert

4. TEST PROCEDURE

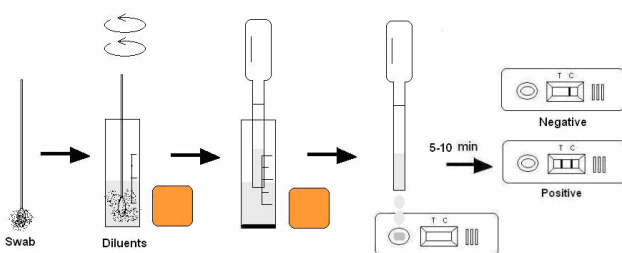

- Warm device to room temperature.
- Coat the swab in a thin layer of dog faeces from a stool sample or cloaca, or coat the swab in a vomit sample.
- Insert the swab into the provided assay buffer tube and agitate for 5 seconds to ensure good sample extraction.
- Remove the cassette from foil pouch and place it horizontally on a flat surface.
- Transfer 3 drops of sample into the sample well "S".
- Interpret the result in 5-10 minutes.
- A result read after 10 minutes is considered invalid.

5. INTERPRETATION OF RESULTS

Positive: The presence of both C band and T band.

Negative: Only clear C band appears.

Invalid: No coloured band appears in C zone, regardless of whether T band appears.

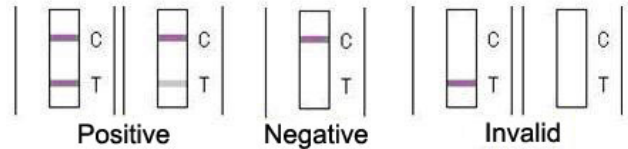

6. STORAGE

The kit can be stored at room temperature (2-30°C, 36-86°F). The test kit is stable until the expiration date marked on the foil pouch. **DO NOT FREEZE.** Do not store the test kit in direct sunlight.

7. PRECAUTIONS

- For best results, please strictly adhere to these instructions.
- All reagents must be at room temperature before running the assay.
- Do not remove test cassette from its pouch until immediately before use.
- Do not reuse the test kit.
- Do not use the test beyond its expiration date marked on the foil pouch.
- The components in this kit have been quality control tested as a standard batch unit. Do not mix components from different lot numbers.

8. LIMITATION

Insight Canine Parvovirus Ag Rapid Test is for in vitro veterinary diagnosis use only. All results should be considered with other clinical information available from veterinarian. If confirmation is required the sample should be tested using an alternative method e.g. PCR.

Woodley Veterinary Diagnostics

a division of Woodley Equipment Company Ltd.

Old Station Park Buildings

St. John's Street

Horwich, Bolton

Lancashire, BL6 7NY, UK

Tel: 0044 (0) 1204 669033

Fax: 0044 (0) 1204 669034

Email: sales@woodleyequipment.com